

**(d) Technical specification:**  
**Technische Daten:**

Rated voltage/ Bemessungsspannung:	max. 230 V AC/DC
Current rating/ Strombelastbarkeit:	6 A at 40 °C 6 A bei 40 °C
Degree of protection/ Schutzart:	IP67/IP69K, in mated condition/ IP67/IP69K im gesteckten Zustand
Temperature range Umgebungstemperatur	-40 °C ... +85 °C
Connector/ Stecker:	
Temperature range Umgebungstemperatur	fixed/ -40 °C... +80 °C fest:
Wire/ Leitung:	moved/ -25 °C... +80 °C bewegt:
Mating cycles/ Steckzyklen:	>=100
Wire cross section/ Anschlussquerschnitt:	0,75 mm <sup>2</sup>
Housing/ Gehäuse:	Deutsch, DT06-8SA-CE02, black / schwarz
<b>Materials/ Werkstoffe:</b>	
Contact/ Kontakt:	Copper alloy/ Kupferlegierung
Contact carrier/ Kontaktträger:	Thermoplastic/ Thermoplastik
Contact plating/ Kontaktoberfläche:	Ni
Overmolding/ Umspritzung:	TPU, UL 94, black/ schwarz
Sealing/ Dichtung:	Silicone/ Silikon

**Contact assignment/  
Kontaktbelegung:**

green/grün	1
brown/braun	2
white/weiß	3
pink/rosa	4
grey/grau	5
yellow/gelb	6
blue/blau	7
red/rot	8

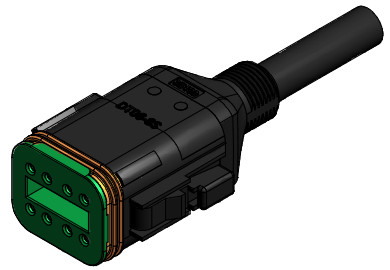

Part-no./ Art.-Nr.:	Description/ Beschreibung	Cable Length "L"/ Kabellänge:	Cable/ Kabel:
55-00532	DT06-8ASG-A/K1/0.75/2m	2,0m	PUR, schwarz / black 8x0.75mm <sup>2</sup> , Kabel / cable: 781-K17800
55-00533	DT06-8ASG-A/K1/0.75/5m	5,0m	
55-00534	DT06-8ASG-A/K1/0.75/10m	10,0m	
55-xxxxx	DT06-8ASG-A/K1/0.75/..m	...m	

tolerance of cable/ Kabeltoleranz:	(d) L <= 5m: L + 50mm L > 5m: L + 1%	dim. in mm	DT04 - 8pos. Plug Valve Connector DT04 - 8pol. Ventilstecker	
general tolerance/ Allgemeintoleranz:	0 ± 0,50mm 0,0 ± 0,25mm 0,00 ± 0,10mm x ± 5°	Date/Datum	Name	
Index:	d Ä6427 13.12.16 K.H.	drawn/ gez.	02.03.15	Strackerjahn
Status:	Freigegeben	appd./ gepr.	18.04.15	Koch
RoHS compliant/ konform	scale/Maßstab: 1,5 : 1 (1:1)	dwg no / Z.-nr.:		55K1A083
	CONEC®			DIN-A3
				1 / 1

The reproduction, distribution and utilization of this document as well as the communication of its contents to others without express authorization is prohibited. Offenders will be held liable for the payment of damages. For further information on this subject, please contact your dealer or the manufacturer CONEC.