

Adaptor, PG - metric

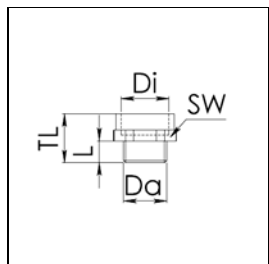

Material: Brass nickel-plated

Adapter, PG-metrisch

Material: Messing vernickelt

Type	WISKA-No. Ni 100.							TL
			mm	mm	mm	mm	mm	mm
AMPM 7/12	63880	100	PG 7	M 12x1,5	5	9	14	15
AMPM 9/16	63883	100	PG 9	M 16x1,5	6	12	19	16
AMPM 11/16	63885	100	PG 11	M 16x1,5	6	13	22	16
AMPM 13,5/20	63889	100	PG 13,5	M 20x1,5	6,5	15,5	24	17,5
AMPM 16/20	63891	100	PG 16	M 20x1,5	6,5	18	27	17,5
AMPM 16/25	63892	100	PG 16	M 25x1,5	6,5	18,5	30	18,5
AMPM 21/25	63894	100	PG 21	M 25x1,5	7	23	32	19
AMPM 21/32	63895	100	PG 21	M 32x1,5	7	23	36	20
AMPM 29/40	63898	50	PG 29	M 40x1,5	8	31,5	43	21
AMPM 36/50	63901	25	PG 36	M 50x1,5	9	42	55	23
AMPM 42/63	63905	10	PG 42	M 63x1,5	10	48	65	25

Adaptor, metric-NPT

Adapter, metrisch-NPT

Type	WISKA-No. Ni 100.							TL
			mm	mm	mm	mm	mm	mm
AMMN 20 · 3/8	62965	20	M 20x1,5	NPT 3/8"	10	15	22	20
AMMN 20 · 1/2	62966	25	M 20x1,5	NPT 1/2"	10	15	27	22,5
AMMN 25 · 3/4	62967	10	M 25x1,5	NPT 3/4"	8	20	32	25
AMMN 32 · 1	62968	10	M 32x1,5	NPT 1"	6	26	40	30

KUNSTSTOFF
PLASTIC

MEMBRAN
MEMBRANE

MESSING
BRASS

DIN 89280

EDELSTAHL
STAINL. STEEL

EMV
EMC

ATEX
ATEX

Ventgl. AND

DICHTUNGEN
SEALINGS

WERKZEUGE
TOOLS

TECHNIK
TECHNICS

INDEX
INDEX